

## Neue Film 2

## Studio 21

### Stage 21

#### Grundriss M 1:250 @A3

Floor Plan 1:250

Studiofläche ges. 1185m<sup>2</sup>  
Total Area 12751ft<sup>2</sup>

Baufläche 46,40 x 20,40m  
Construction Area 152,19 x 66,91ft

Bauhöhe max. 7,50m / 10,20m  
Construction Height 24,60ft / 33,46ft

max. Bodenbelastung 1000kg/m<sup>2</sup>  
max. Floor Load Capacity 200lb/ft<sup>2</sup>

Alle Maße sind vor Ort zu prüfen.  
All measurements are to be checked on site.

#### Stage 20/21

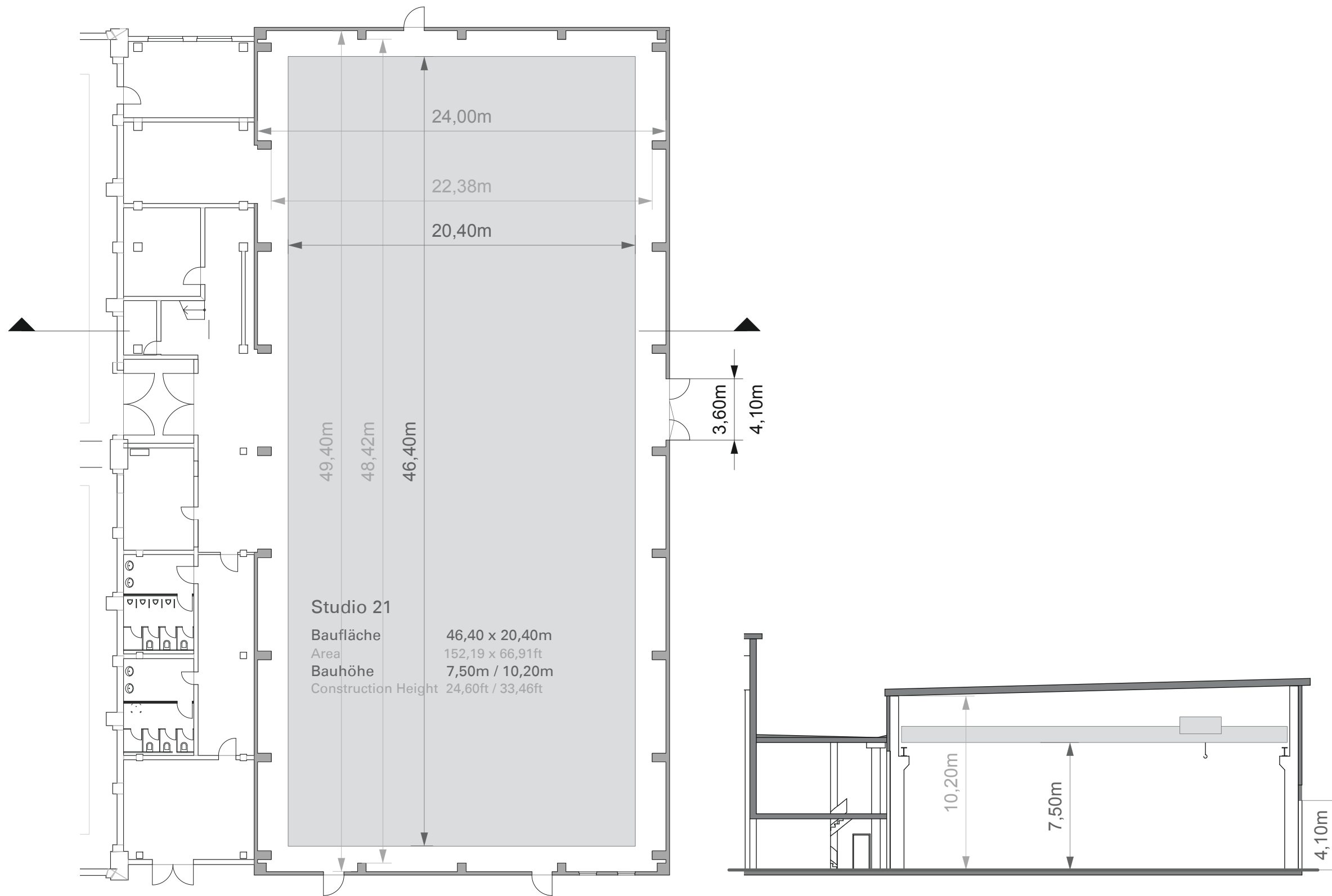
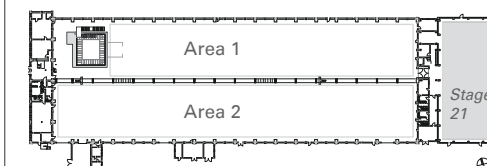

#### Kontakt:

Contact: Stage Rental

**Studio Babelsberg AG**  
Studio- und Atelierbetrieb  
August-Bebel-Straße 26-53  
14482 Potsdam

+49 (0) 331 / 721 21 06

StageRental@studiobabelsberg.com

[www.studiobabelsberg.com](http://www.studiobabelsberg.com)